



The site, located in Solihull to the south of Birmingham, is currently a Christmas tree farm with a small residential area along its eastern edge. The proposed layout emphasises expansive green spaces that flow naturally throughout the development, each featuring unique character areas, as detailed later in this document.

A standout element of the design is the preservation of the existing trees that hold wildlife value, which are thoughtfully integrated into the landscaping plans. One of the site's key features is a pond near to the eastern boundary, serving as the focal point of the public open space (POS). This area will include an amphitheatre, a community garden, and timber decking extending over the pond. Additional POS spaces are scattered throughout the development, offering amenities such as a community orchard, wildlife observation decks, picnic spots, mowed lawns, and native planting. The site features a total of three existing ponds and ten new attenuation ponds/ swales, all set within natural landscapes that provide ample opportunities for residents to explore and enjoy.

Tree planting plays an important role in creating a clear green infrastructure highlighting key routes through the development, achieving a sense of arrival and utilised as way finder markers. The layers of trees create visual appeal whilst benefiting the site's biodiversity value and offering seasonal interest.



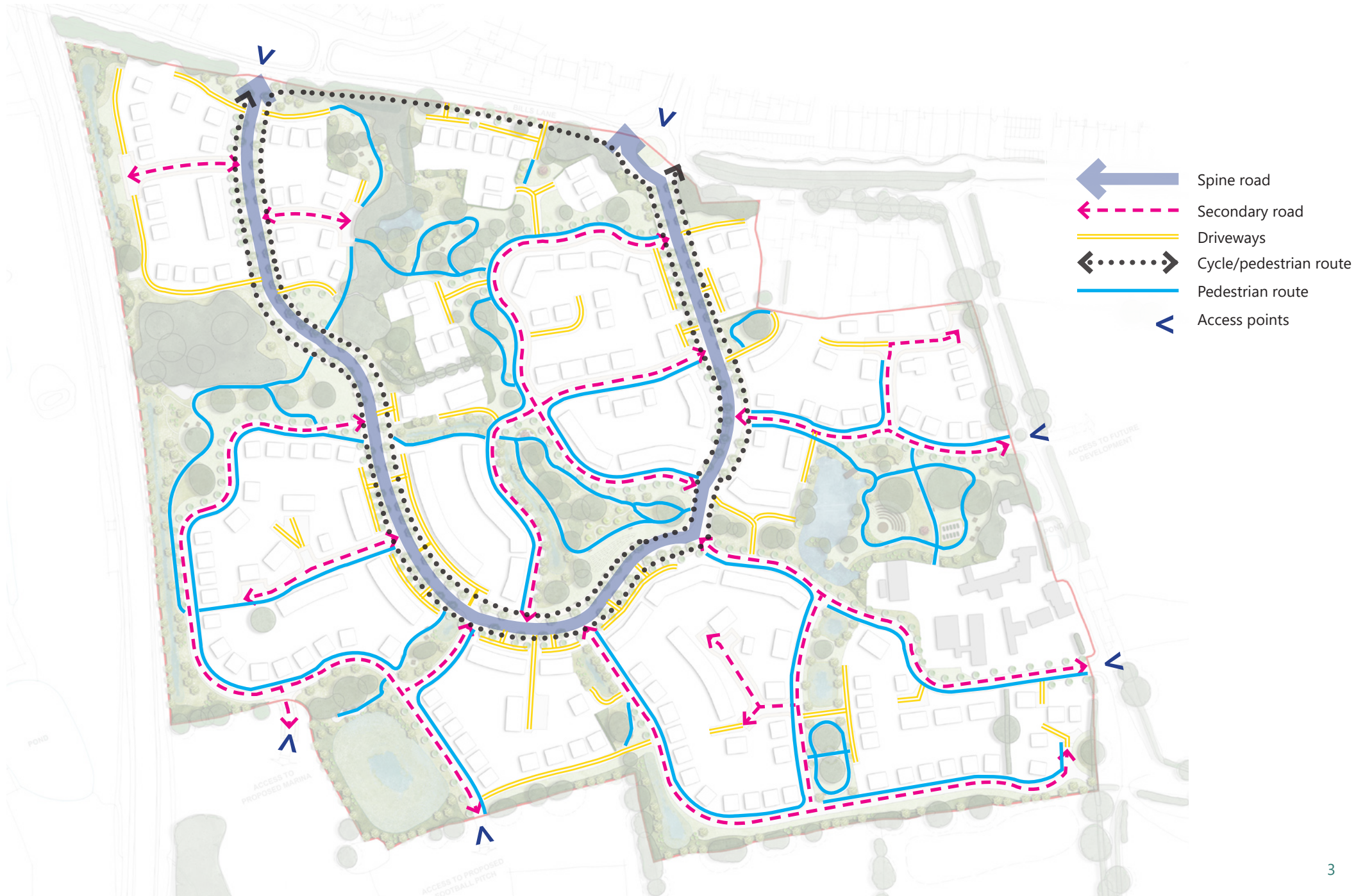





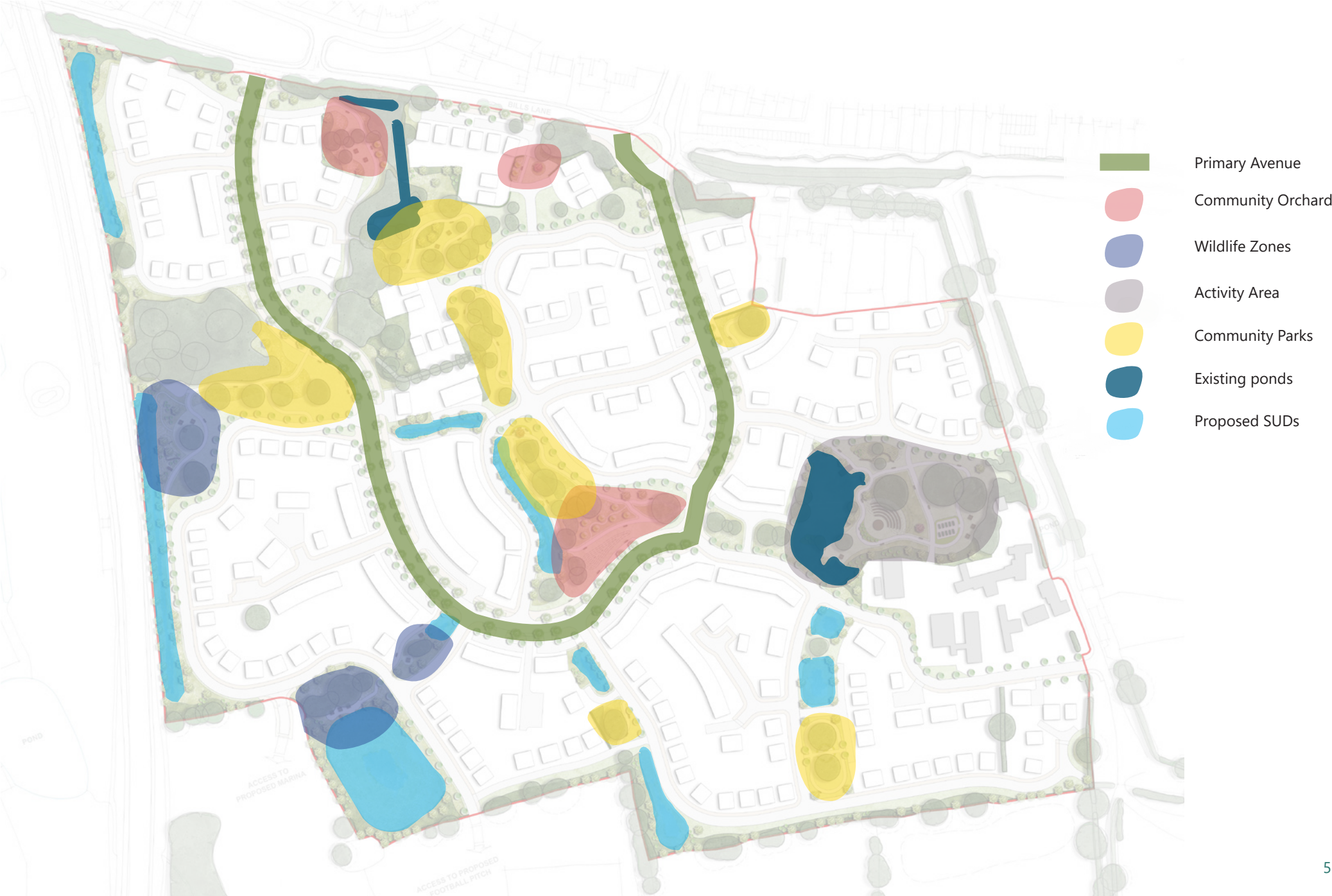





Feature tree



Community orchard



Wildflower meadows



Proposed picnic tables

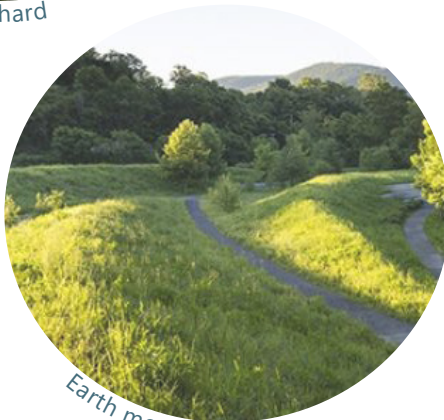

Earth mounds

The residential scheme includes three community orchard areas, with the largest situated in the central public open space (POS). Fruit trees are planted within wildflower meadows, either lining the main path or accessible via mowed grass pathways. In addition, an earth mound in the central POS offers natural screening, creating a peaceful and private retreat away from the main avenue.





This area fosters a deeper connection to nature, with dense plantings of trees, shrubs, and meadows for residents to explore and enjoy. Picnic tables are strategically placed for easy access, while timber viewing decks offer perfect spots for wildlife observation. The decks are positioned over a natural terrain depression, featuring elements such as fallen tree trunks, stepping logs and stones, and small clusters of trees.

Picnic tables with a viewing deck at the meadow and attenuation pond

Attenuation pond

Dense planting of native tree species, such as Silver Birch to create a green buffer from the road



Attenuation ponds



Trim trail set in the flower meadow



Wildlife friendly planting



Viewing decks for wildlife watching





At the heart of the public open space (POS) lies a large pond, around which the activity area is designed to offer a variety of spaces for residents to enjoy. The area includes an amphitheatre surrounded by a wildflower meadow and a proposed dense birch forest, with a community garden located on the opposite side of the main path that runs through the space. Nearby, picnic tables provide ideal spots for social gatherings. The area also features numerous benches along the pathways and a timber deck that extends over the pond. Above the decking, a trim trail meanders through stepping logs, earth mounds, and wildflower meadows. The entire space is thoughtfully bordered by abundant native planting and existing vegetation, creating a serene and welcoming environment.



Natural trim trail



Existing pond with flower meadow



Proposed community garden



Proposed amphitheatre





Existing pond

Picnic tables set in a mowed grass, surrounded by wildlife planting

Existing trees in this area are mainly varieties of pine and other coniferous species as well as Holm Oak.

Attenuation pond

Gathering and seating area



Large avenue trees

Mowed lawn

Wildflower meadow

Community parks form a network of interconnected green spaces that flow seamlessly through the development, providing residents with an almost continuous green corridor. These parks include welcoming gathering and seating areas, flower meadows, expansive lawns, and dense clusters of both existing and newly planted trees and shrubs, offering a vibrant and varied landscape ideal for relaxation and recreation.



Picnic tables



Paths and seating spaces